



# Royal Industrial Suppliers

Quality Fasteners Specialist

No. 4, M.G.S. Complex, Benki Nawab Street, S.P. Road Cross, Bangalore 560002

An ISO 9001:2015 Certified Co



8310165941 / 9008782885



sales@royalfastenersindia.com



www.royalfastenersindia.com

CATALOGUE NUMBER: **R6D15L**

## LONG HEX NUT (COUPLER NUT)

DIN 6334

HEIGHT = 3 x d

**AINI 316 A4**

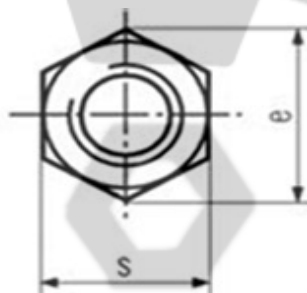
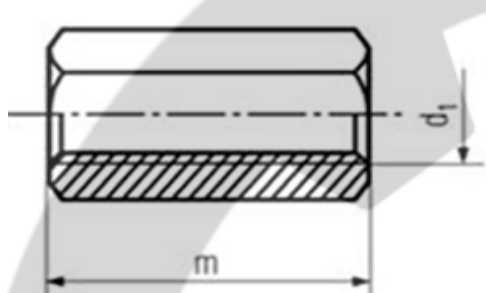

Send your Orders / Enquiries along with the following Item Codes

All Dimensions are in MM

Nominal Size d Thread Size ↓	PART NO.	Width Across Corners	Width Across Flat s		Thickness / Nut Height	
		e	Min	Max	m	Tol
<b>M4x0.7</b>	R6D15L04012	7.66	6.78	7.00	12.0	±0.35
<b>M5x0.8</b>	R6D15L05015	8.79	7.78	8.00	15.0	±0.35
<b>M6x1.0</b>	R6D15L06018	11.05	9.78	10.00	18.0	±0.35
<b>M8x1.25</b>	R6D15L08024	14.38	12.73	13.00	24.0	±0.42
<b>M10x1.5</b>	R6D15L10030	18.90	16.73	17.00	30.0	±0.42
<b>M12x1.75</b>	R6D15L12036	21.10	18.67	19.00	36.0	±0.50
<b>M14x2.0</b>	R6D15L14048	24.49	21.67	22.00	48.0	±0.50
<b>M16x2.0</b>	R6D15L16048	26.75	23.67	24.00	48.0	±0.50
<b>M18x2.5</b>	R6D15L18060	29.56	26.16	27.00	60.0	±0.60
<b>M20x2.5</b>	R6D15L20060	32.95	29.16	30.00	60.0	±0.60
<b>M22x2.5</b>	R6D15L22072	35.03	31.00	32.00	72.0	±0.60
<b>M24x3.0</b>	R6D15L24072	39.55	35.00	36.00	72.0	±0.60
<b>M30x3.5</b>	R6D15L30090	50.85	45.00	46.00	90.0	±0.70

Sizes in BLUE are non-preferred. Availability is limited and MOQ is higher.

Data is strictly informative.

Note: All Austenitic Stainless Steel Fasteners may exhibit some Magnetic Properties due to the Manufacturing Process.

Refer: ISO 3506-2 Annex F